



TINA2 PLUS

unboxing guide

Scan and download the app ,
watch the unboxing video.



| NOTES

Please read this guide before using the device. Once you use this product, it means that you have read and accepted the following safety warnings.

For the full manual, please visit our support page at <https://sansystechology.com/support/>

OR scan the QR code on the printer. For any questions, contact us at: amazon@mlcdistribution.com

| SAFETY WARNINGS

1. Do not touch the nozzle or stepper motors, when the 3D printer is printing or just finished the printing job, the nozzle temperature is up to 230°C.
2. Do not expose this device to water or moisture of any kind. Do not place drinks or other containers with moisture on or near the device. If moisture does get in or on the device, immediately unplug it from the power outlet and allow it to fully dry before reapplying power.
3. Prior to operation, check power cord for physical damage. Don't use if physical damage has occurred.
4. Before plugging the unit into a power outlet, ensure that the outlet provides the same type and level of power required by the device.
5. Unplug this device from the power source when not in use.
6. Take care to prevent damage to the power cord. Do not allow it to become crimped, pinched, walked on, or become tangled with other cords. Ensure that the power cord does not present a tripping hazard.
7. Never unplug the unit by pulling on the power cord. Always grasp the connector head or adapter body.
8. Ensure that the 3D printer is turned off and unplugged from its power source before making repairs or performing service.
9. For more information, please refer to the video, manual, and software from our site: <https://sansystechology.com/support/>

| ACCESSORIES

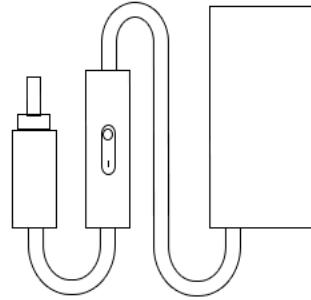
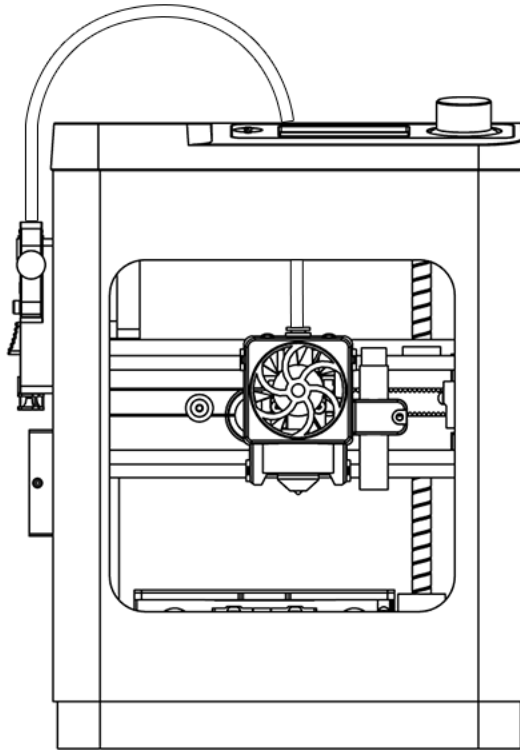

Power Supply

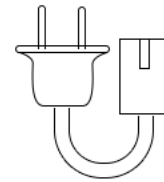

Power Cable



PLA Filament



Type-C



Card Reader

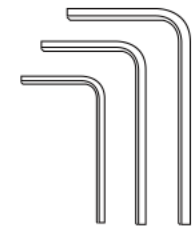

1.5/2.0/2.5 mm
L Wrench

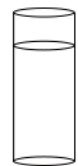

Glue Stick

Applied on the platform
to increase adhesion



Cleaning Needle

Used to unclog the nozzle
for minor blockages

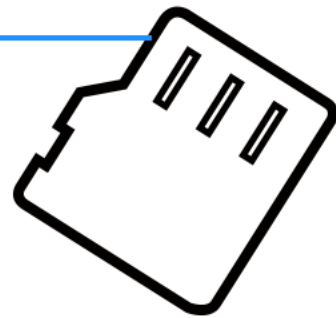
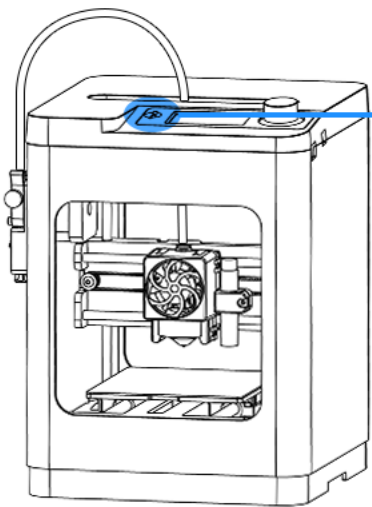

TF card

Test Models

Select the test model to begin printing.

Slicing Software

Wiibuilder | Customized Cura

Insert the TF card into the computer to get the installation package for the slicing software.

Manual

Instructions for using the 3D printer.



Note

The TF card is already inserted into the 3D printer. Repeated insertion and removal may cause wear to the TF card or the slot.

| SPECIFICATION

Model TINA2PLUS V3	Product Volume 210*210*290 mm	Build Volume 100*110*100 mm	Motherboard R72R
Weight 3Kg/6.6lbs	Nozzle Diameter 0.4mm	Power Input 100-240V~50/60Hz	Output 12V@8A,96W
Nozzle Temp ≤245°C	Heatbed Temp ≤80°C	Speed ≤150mm/s	Print Methods TF Card / App / Wi-Fi
Layer Thickness 0.1~0.4mm	Platform PEI build surface	Leveling Tech 9-Point Auto Bed Leveling	Environmental 15°C - 25°C

| SOFTWARE

Slicing Software Wiibuilder (Win/Mac) Cura (Win/Mac) Kiri (Chrome OS/ iPad)	Input File Format STL / OBJ / AMF	Print Format G-code	App Poloprint Cloud (Android/iOS)
---	---	-------------------------------	--

| FILAMENT

Filament Type PLA / PLA+ / TPU / PETG	Filament Diameter 1.75mm	Filament Temperature <245°C	Filament on Holder ≤500g
---	------------------------------------	---------------------------------------	------------------------------------

Please use the filament provided by our company. Filaments have different specifications, which can clog and damage the nozzle. If the 3D printer fails due to other brand filament, the warranty will not be granted. If the filaments are not used for a long time, please keep them sealed.

PRODUCT OVERVIEW

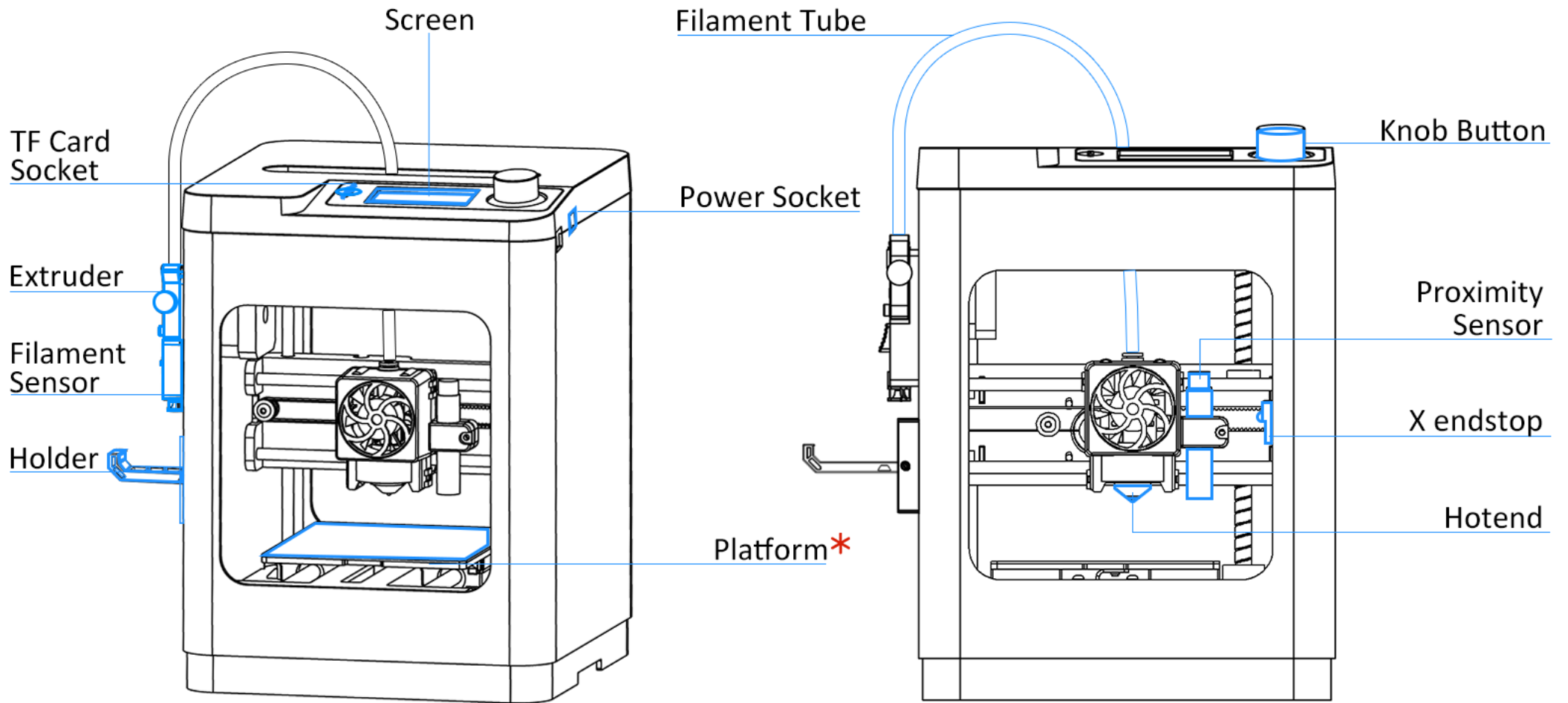

! Note

The platform is a consumable item, and minor scratches or burns will not affect normal usage. However, if it loses adhesion after extended use, it will need to be replaced with a new one.

UNBOXING

1 Remove the 3D printer and accessories from the box.

2 Remove all fixtures.

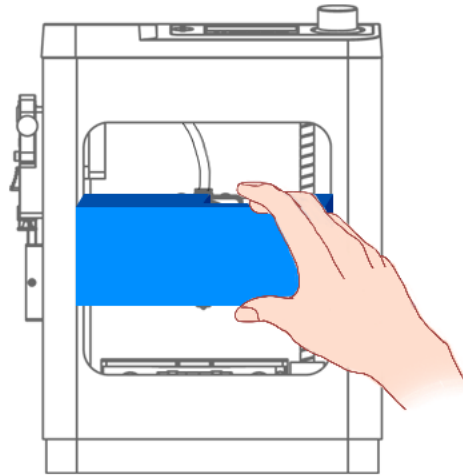

1. Remove the bubble wrap.

V

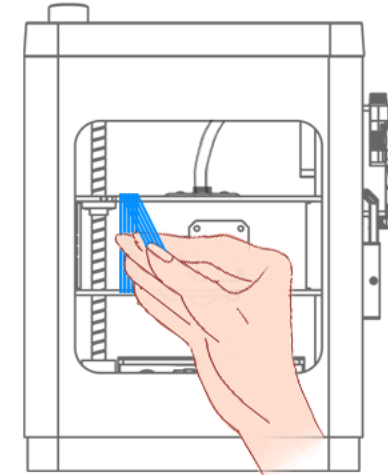

2. Peel off the tape.

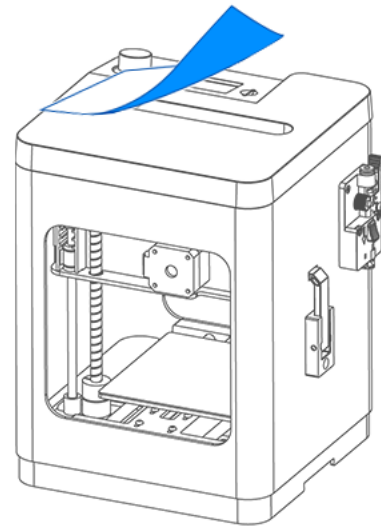

3. Remove the sticker.

V

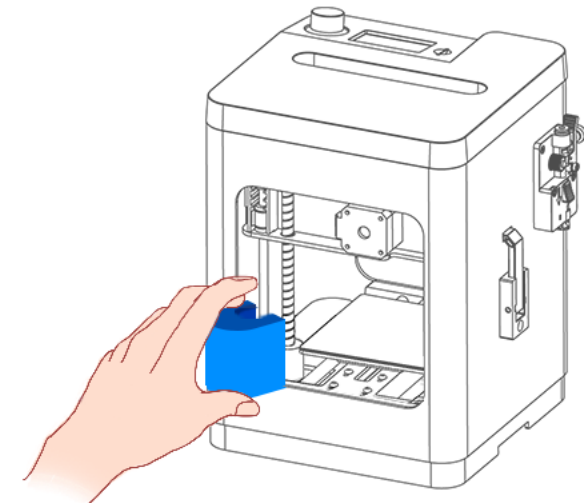

4. Remove the shaft coupling shell.

3 Insert the tube, plug in the power and turn it on.

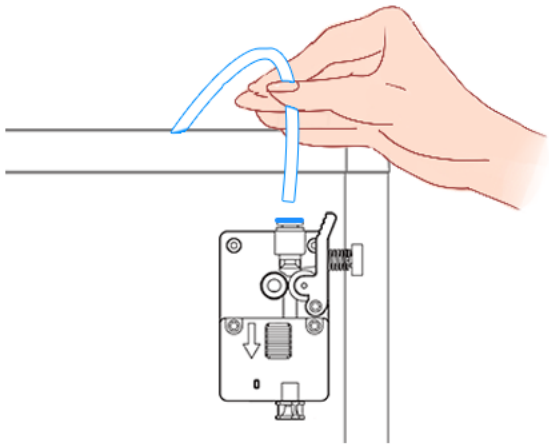

1. Insert the tube into the extruder.

V

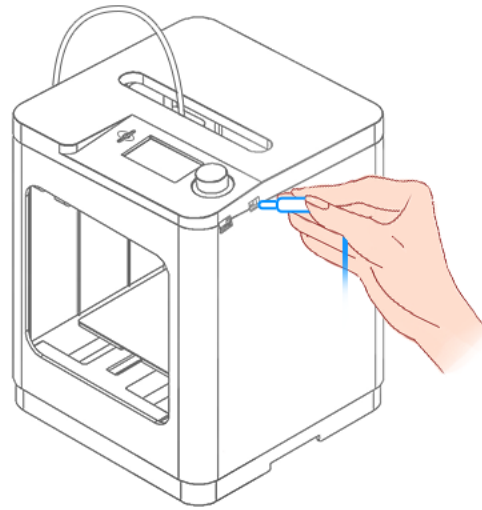

2. Plug in the power.

V

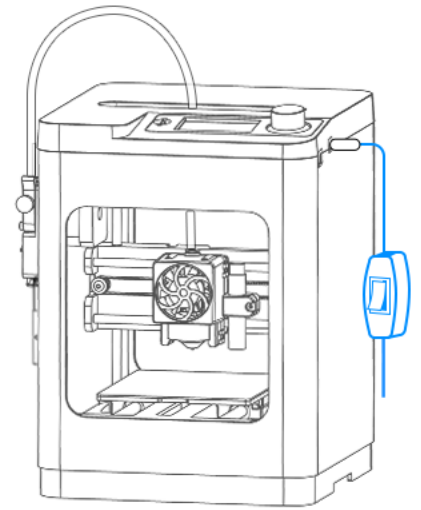

3. Turn on the printer.

4 Insert the filament, and perform the loading operation.

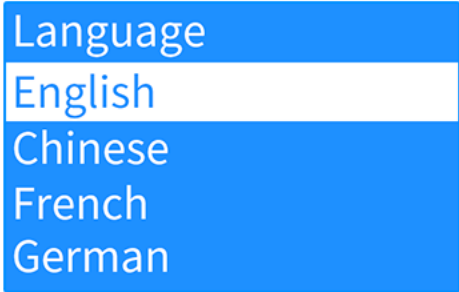

1. Select the language.

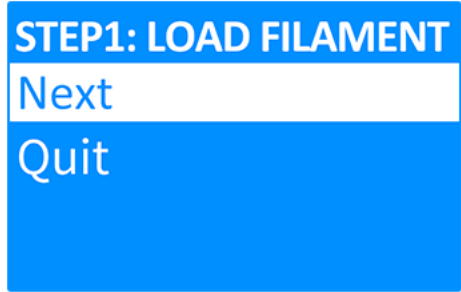

2. Turn the knob to select "Next".

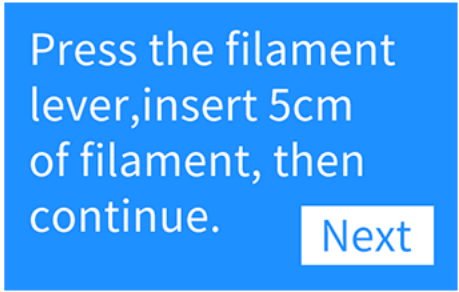

3. Follow the on-screen instructions.

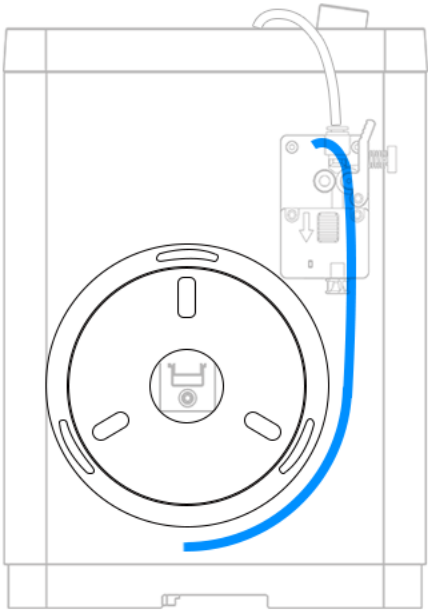

4. Take out the filament and place it on the holder.

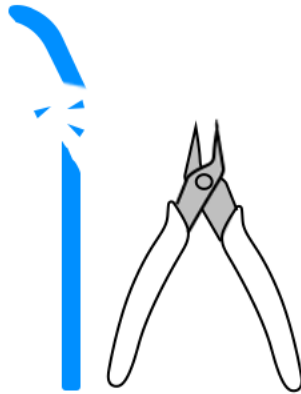

5. Cut off the bent part to prevent clogging.

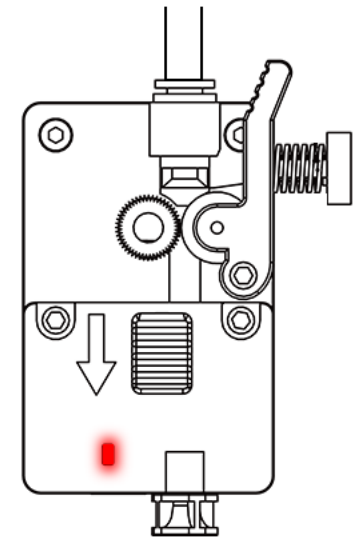

6. The indicator light will turn on when there is no filament.

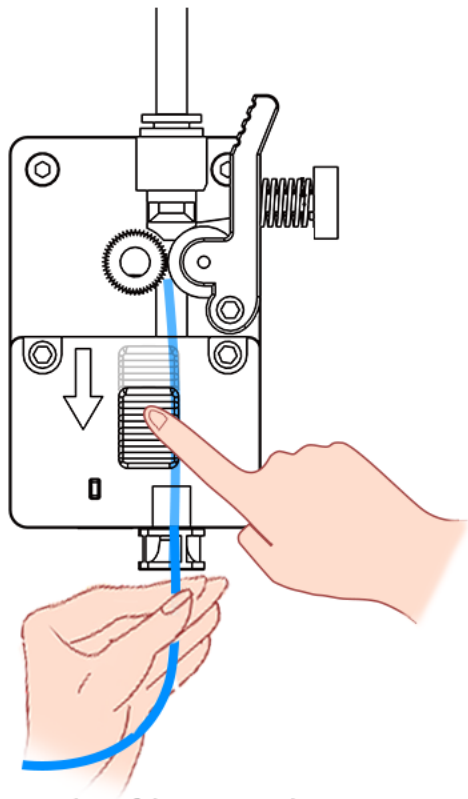

7. Press the filament lever and insert 5 cm of filament.

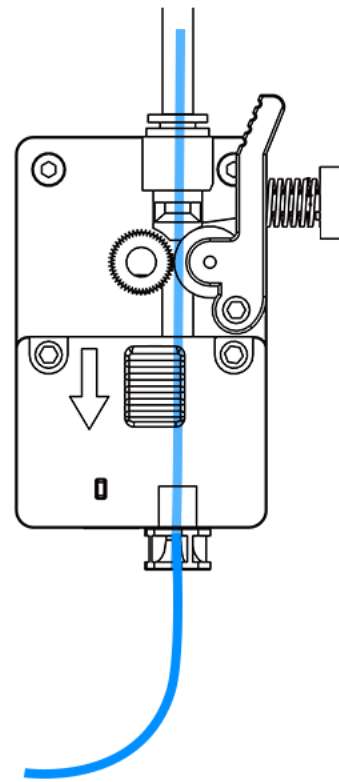

8. The printer will automatically load 4 cm of filament.

Press the filament lever, insert 5cm of filament, then continue. [Next](#)

9. Click "Next".

Load Filament
Wait for
filament load
click to skip
Nozzle:E1 220/220

10. Wait for the filament to load into the nozzle.

Load Filament
Wait for
filament purge
click to skip
Nozzle:E1 220/220

11. Wait for 15 cm of filament to be purged.

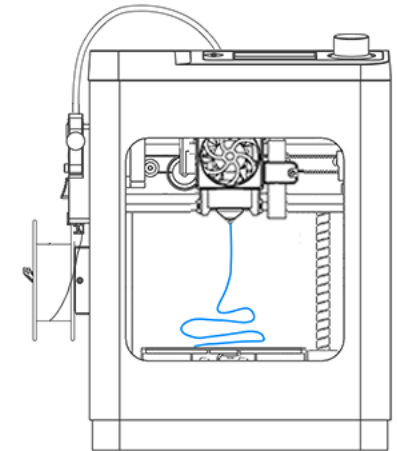

12. About 15 cm of filament will come out of the nozzle.

5 Get the QR code.

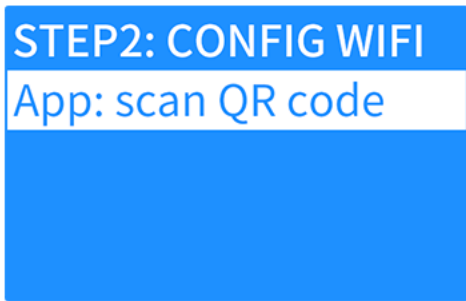

1. Press the knob to select "App: Scan QR Code".



2. The device will display its unique QR code.



3. Scan the QR code with the **Poloprint Cloud** app to pair the device.

| PRINT MORE MODELS USING THE APP



The device needs to be configured for the network and registered in your account.

The device will display the IP after it is connected to the network.

The device will show "Online" in the app after it is registered to your account.

Note: If you have already followed the app's guided instructions, please ignore the following steps.

1 Configure wifi network.

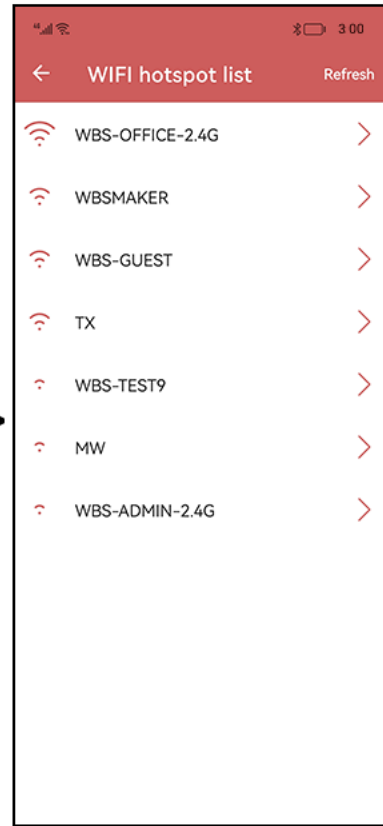
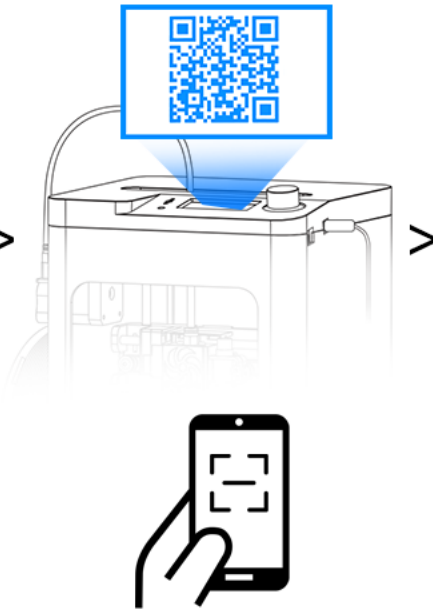
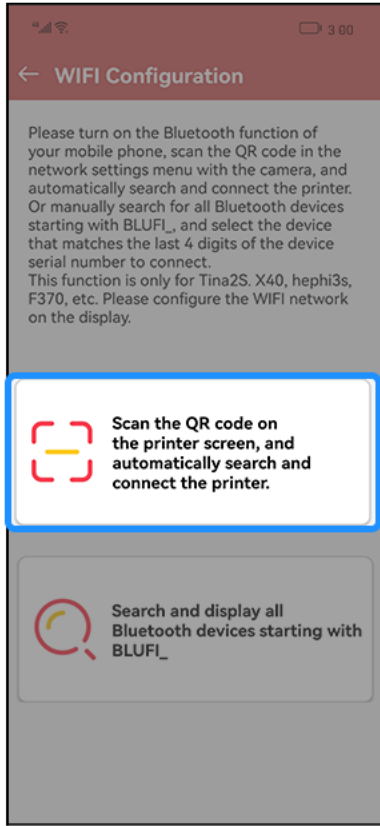
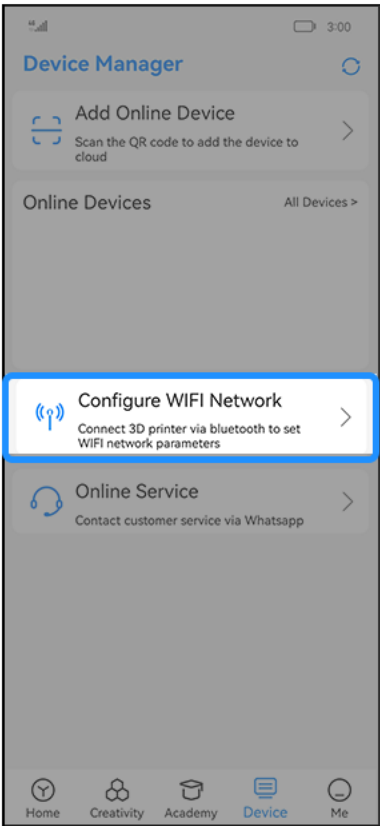

1. Choose "Wi-Fi Configuration".

2. Click "Scan".

3. Scan the QR code.

4. Select WiFi, enter your WiFi password.

5. The device displays the IP.

Note: The list will only show 2.4G network. Doesn't support 5G.

2 Register the device in your account.

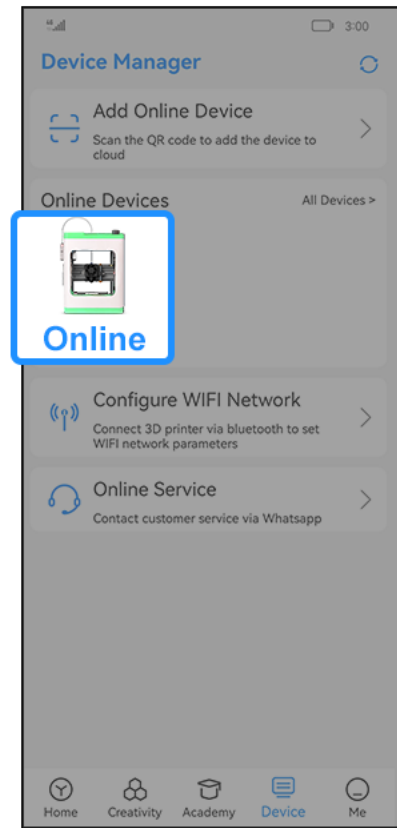
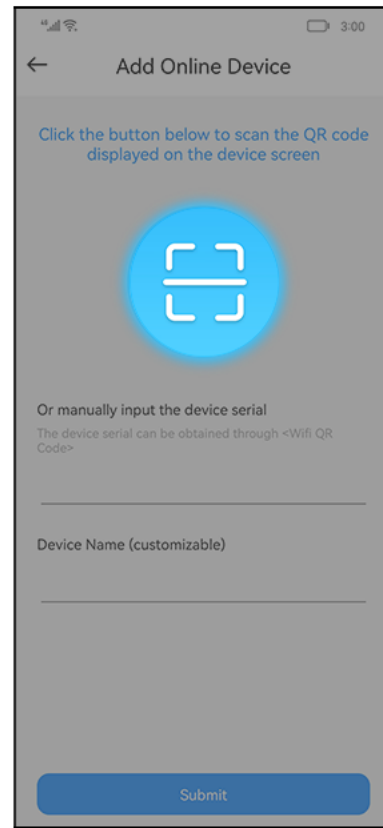
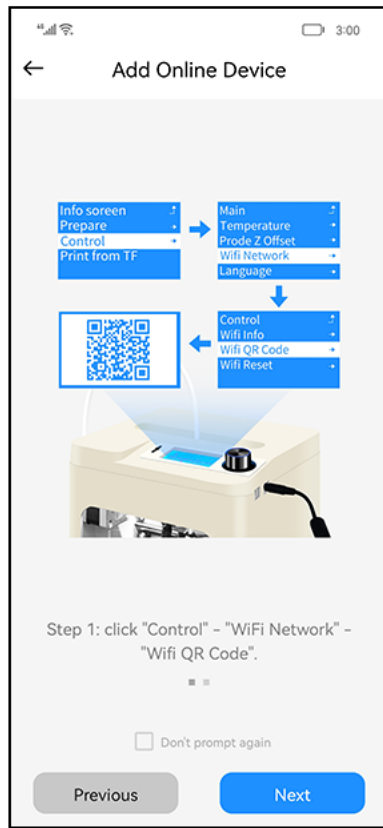
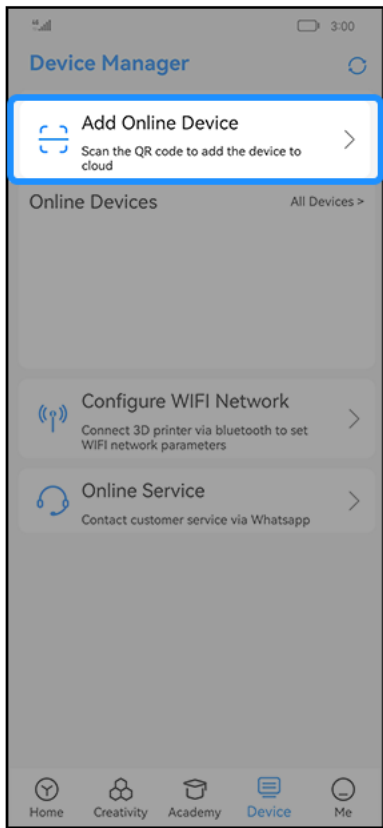

1. Click "Add Online Device".

2. Click "Next".

3. Scan and submit.

4. The device shows "Online" in the app.

Note: You must register this device in your account to use online control and printing. Each device can only be bound to one account. To use it with a different account, please unbind it from your current account first.

How to Unbind a Device:

The device needs to be unbound from the old account before linking it to a new one in the following cases:

- When the printer is shared within a household;
- When the device is linked to another account (such as an Apple, email, or Google account).

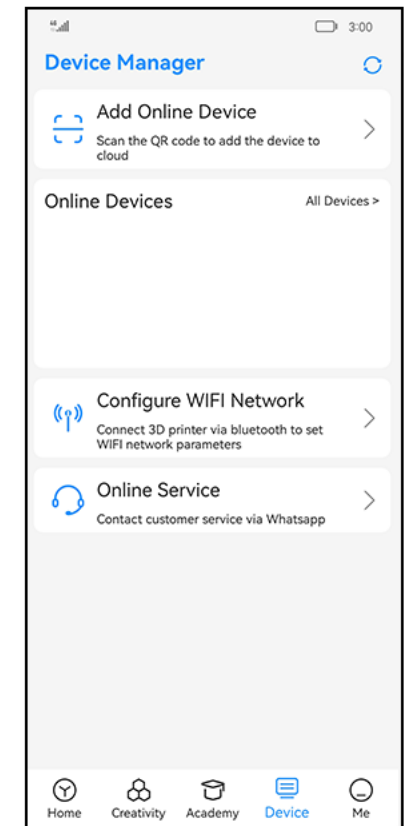
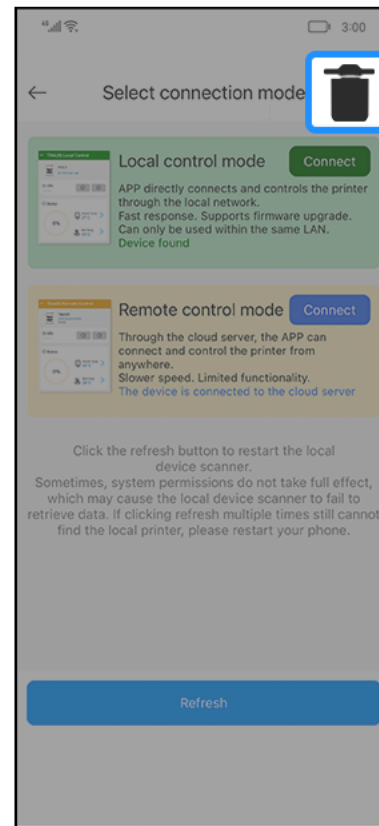
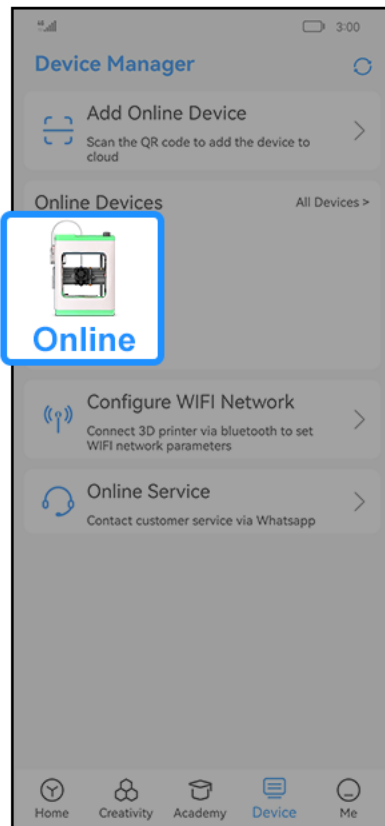

1. Click on this device.

2. After navigating to the "Control Devices" page, tap the "Delete" icon.

3. The device will be deleted from the account.

3 Print more models.

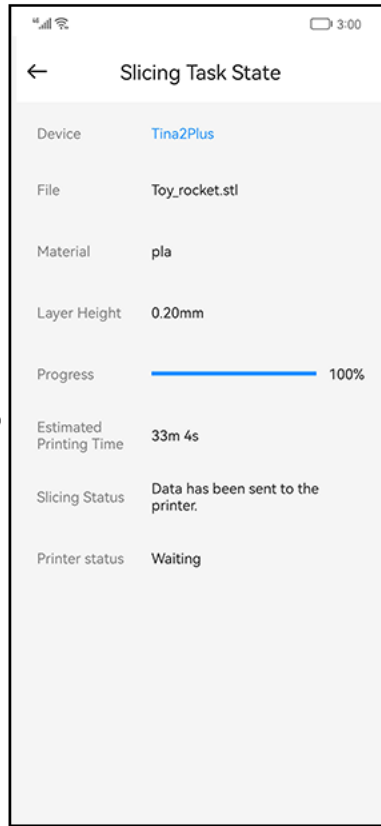
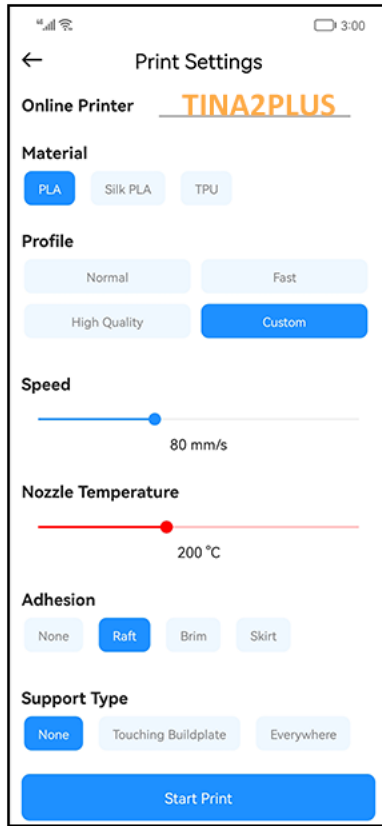
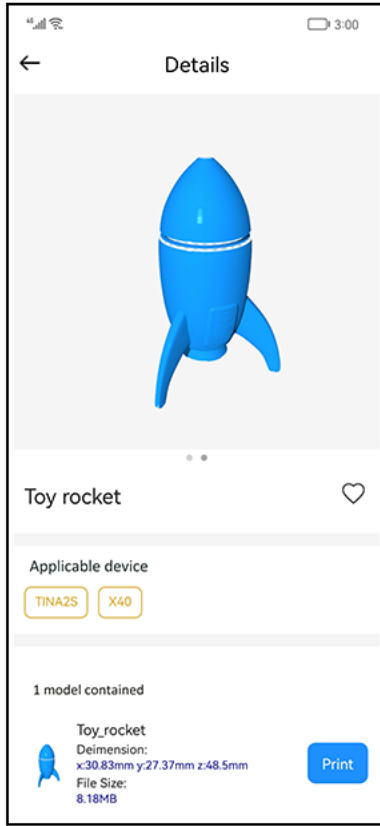
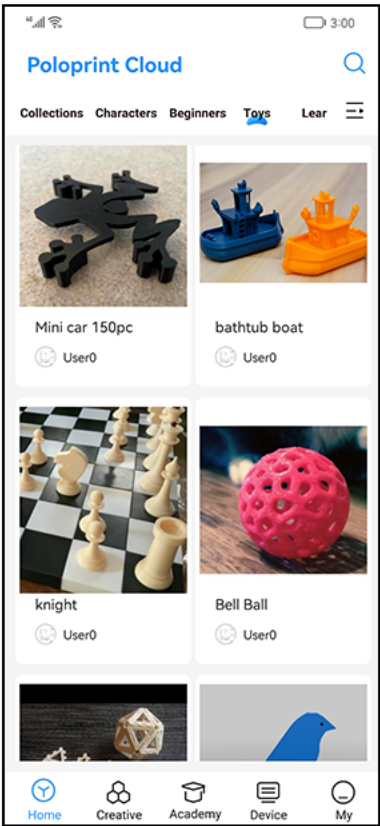

Downloading:
Rocket.gcode
25%

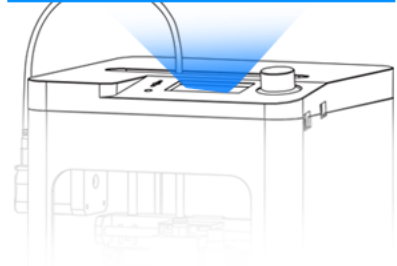

1. Choose a model.

2. Click "Print".

3. Click "Start".

4. Waiting for the slicing.

5. Waiting for download.

Note: Make sure the TF card is inserted, otherwise file transfer will fail.

| PRINT MORE MODELS USING THE COMPUTER

3D models from websites are typically in STL format and cannot be printed directly by 3D printers. The model needs to be processed in slicing software to generate G-code files for printing.

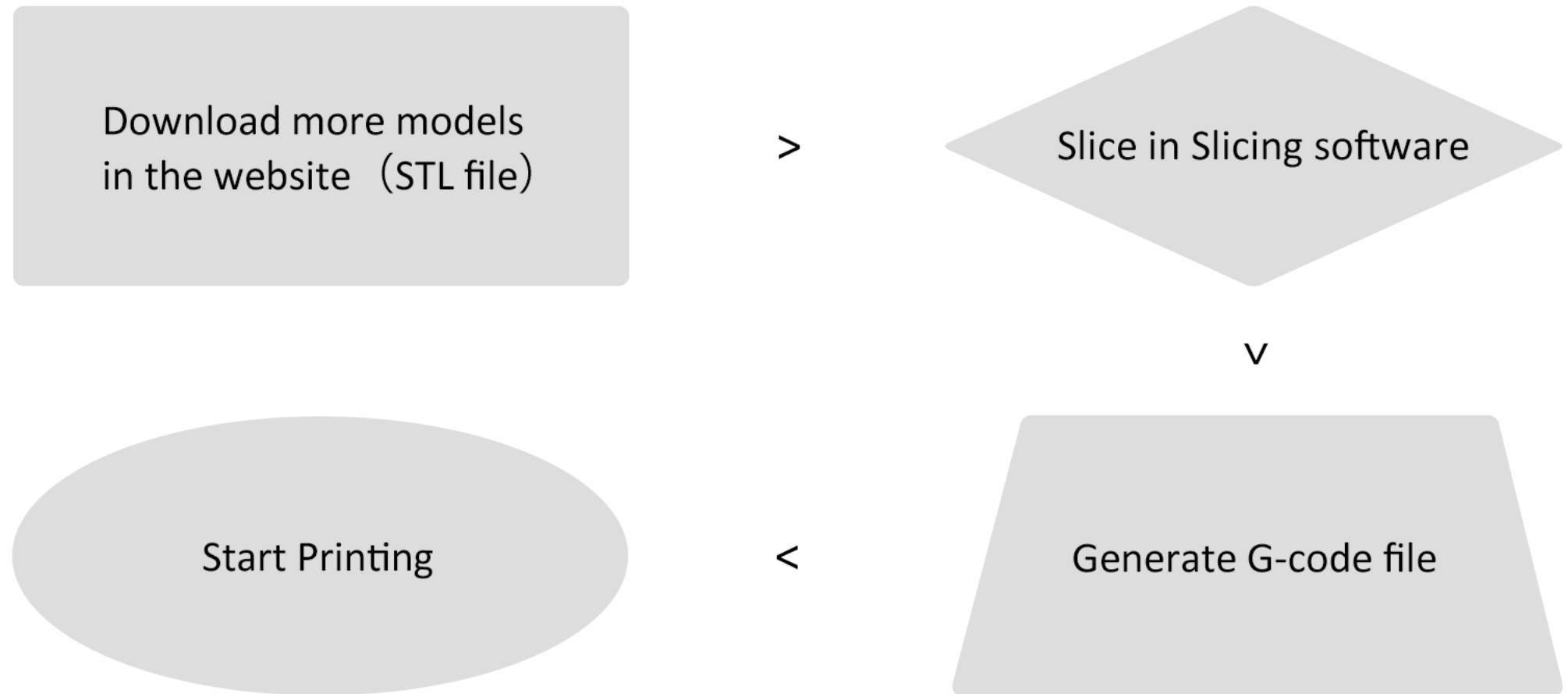

Note: 1. Slicing software is installed on the computer. Common options: Wiibuilder, Cura.
2. Wiibuilder is our in-house developed software with a user-friendly interface. It is recommended.

1 Download more models in the website.

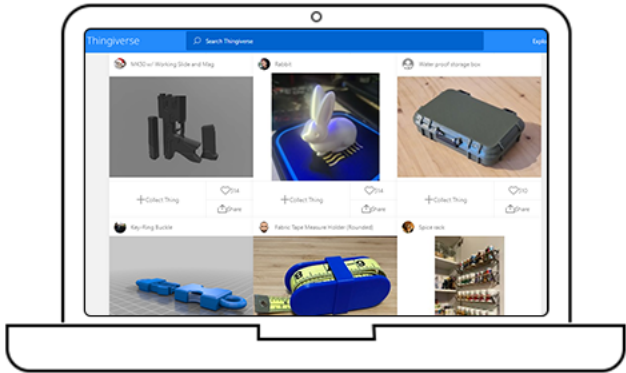

1. Visit a 3D model website such as Thingiverse or Printables.

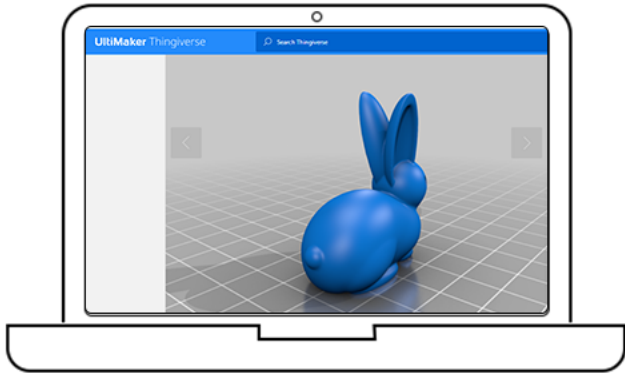

2. Select the model you want and download the STL file.

2 Install slicing software.



1. Copy the installation file from the TF card to your desktop, then unzip it.

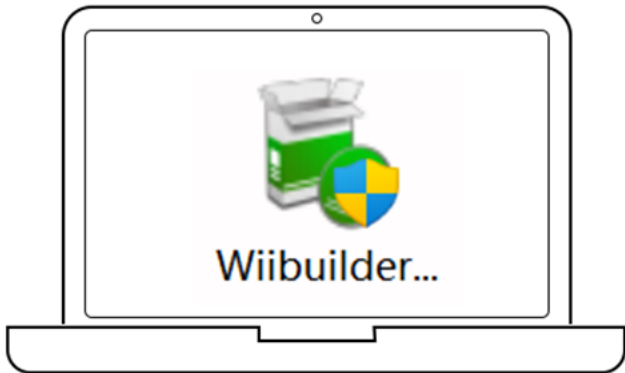

2. Double-click the program to install Wiibuilder on the computer.

3 Slice in Slicing software, and get Gcode file.



1. Open Wiibuilder.

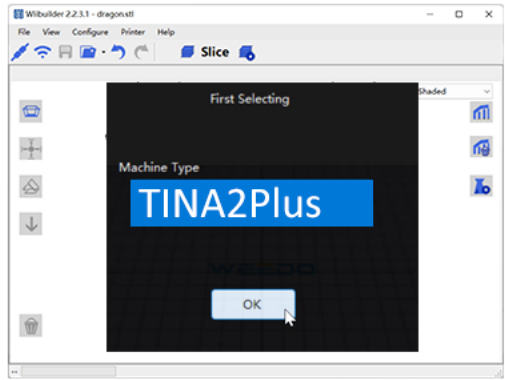

2. Be sure to choose "TINA2Plus".

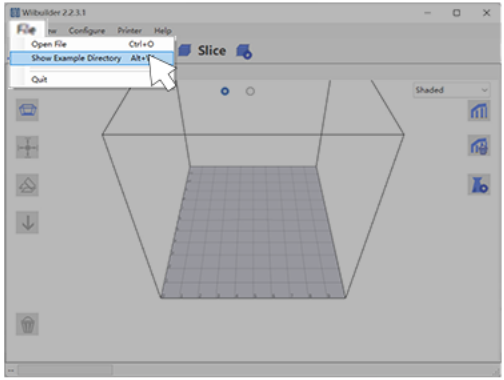

3. Click "File" to load the STL file, or just drag the model into it.

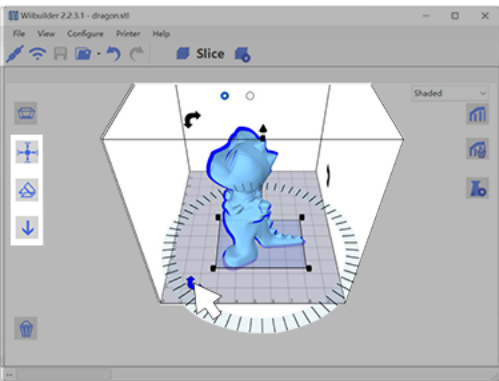

4. Click and adjust the model.

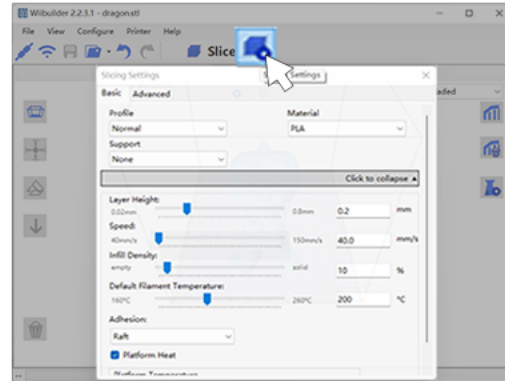

5. Set slicing parameters .

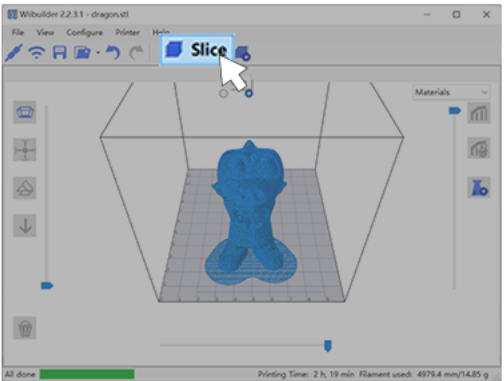

6. Click "Slice" to generate the G-code file.

Note: For detailed slicing instructions, refer to the user manual on the TF card.

4 Print through Wi-Fi

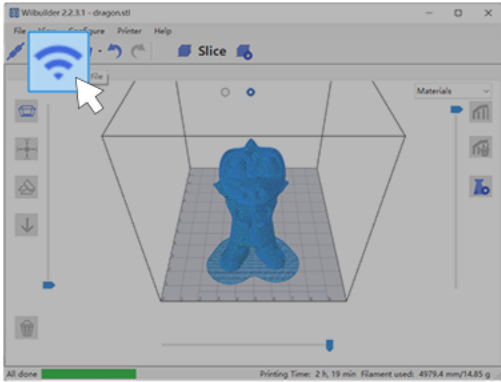

1. Tap "WLAN Connection".

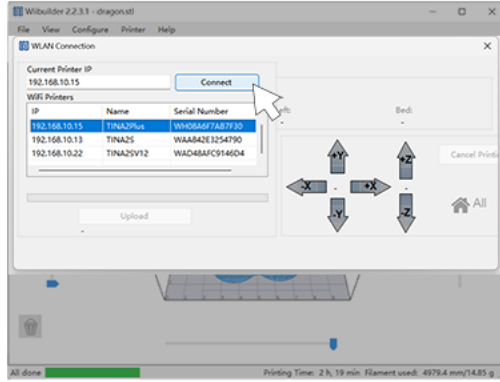

2. Enter or select the device IP.

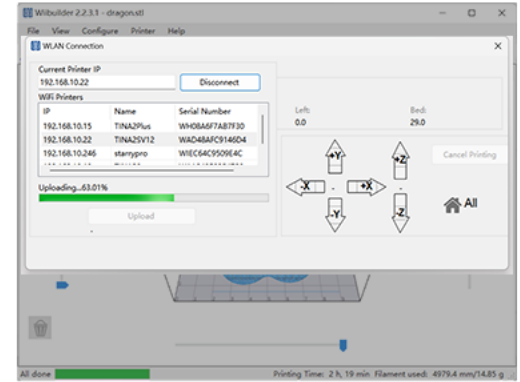

3. Tap "Upload" and make sure your computer remains awake.

5 Print complete, remove the model.

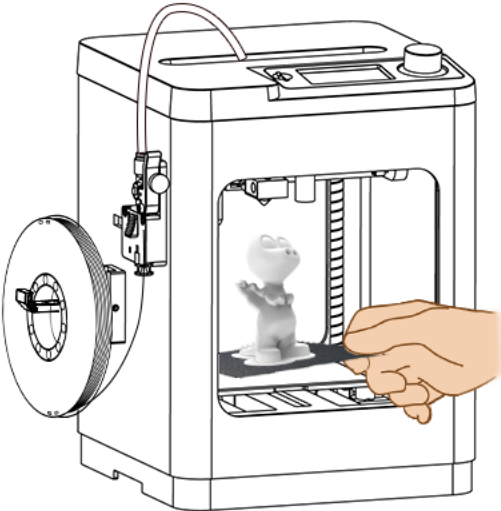

1. After the print is complete, remove the platform.

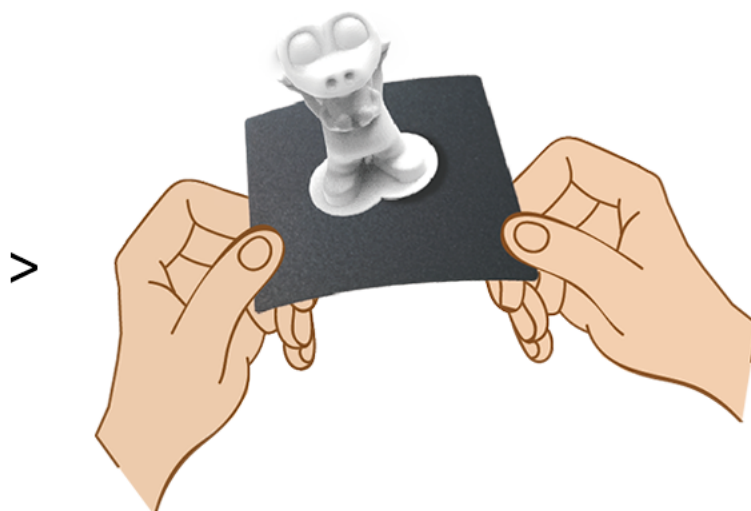

2. Gently bend the platform with both hands, and the model will come off.

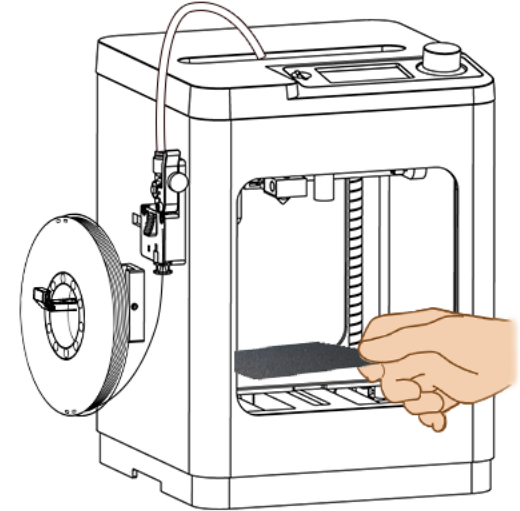

3. Return the platform to its original position.

| COMMON OPERATIONS

① How to change the filament?

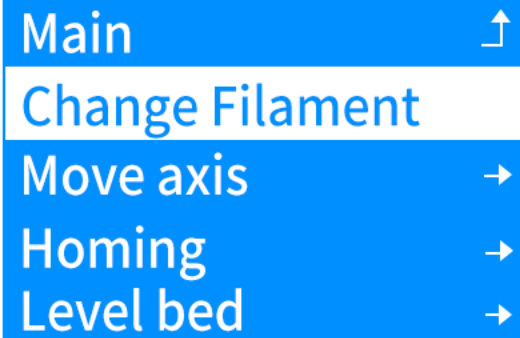

1. Rotate the knob on the screen to select “Change Filament.”

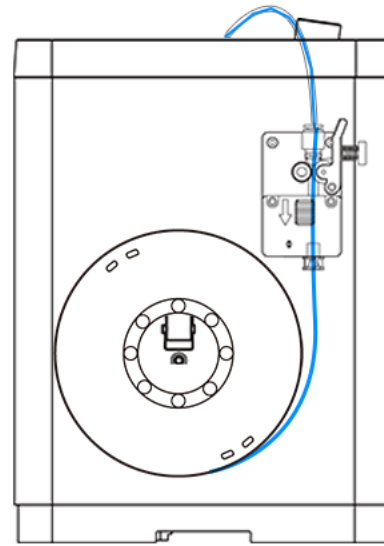

2. Follow the prompts to remove the old filament and load a new one.

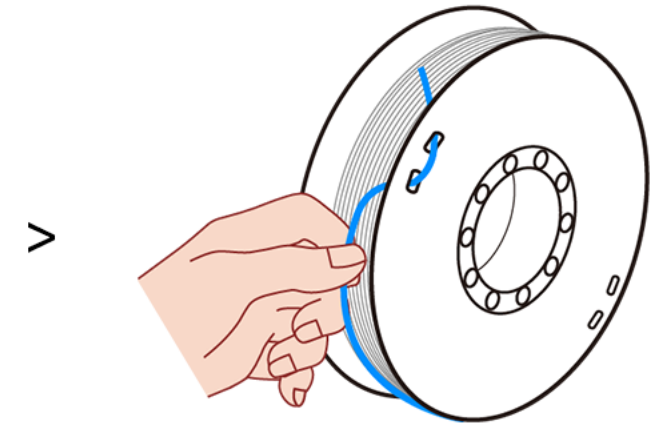

3. Insert the filament end into the spool hole to prevent tangling.

Tip: 1. Please follow the steps above to change the filament. Do not pull the filament out directly, as this may clog the nozzle.
2. Make sure to seal and store the removed filament properly, as moisture and dust can make it unusable.
3. If the filament is not secured properly, loose coils may get tangled, which can cause feeding issues or appear like a clog during the next use.

② What should I do if the nozzle is clogged?

The nozzle will be clogged due to the damp filament, so the nozzle should be cleaned regularly. For general clog, you can clear it using a cleaning needle. If the issue persists, the nozzle may need to be replaced. Please refer to the tutorial in the app for instructions.



1. Click "Load Filament" and wait for heating to 240°C.

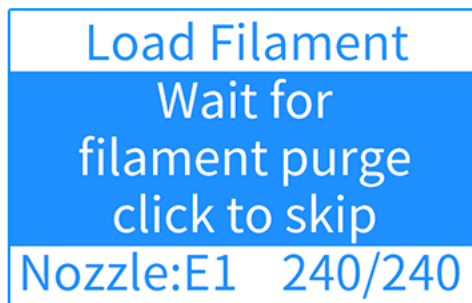

3. The filament will automatically load when heated to 240°C. Handle carefully to avoid burns.

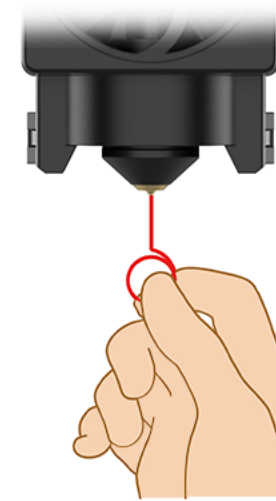

2. Push a needle through the nozzle, approximately 10 times.

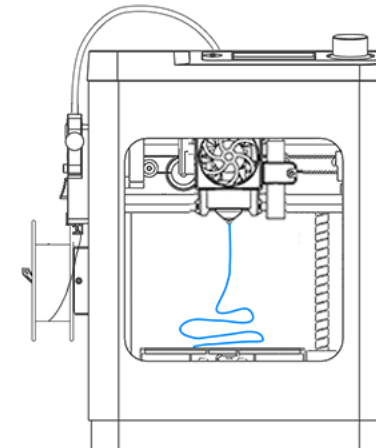

4. If the blockage has been cleared, the filament will slip through the nozzle.

③ What should I do if my model doesn't stick?



A common issue with non-adhesion includes: ① the first layer warping or detaching from the build plate; ② the model detaching from the platform during printing; ③ the nozzle printing in mid-air, resulting in a mess of tangled filament.

You can resolve this using the following steps:

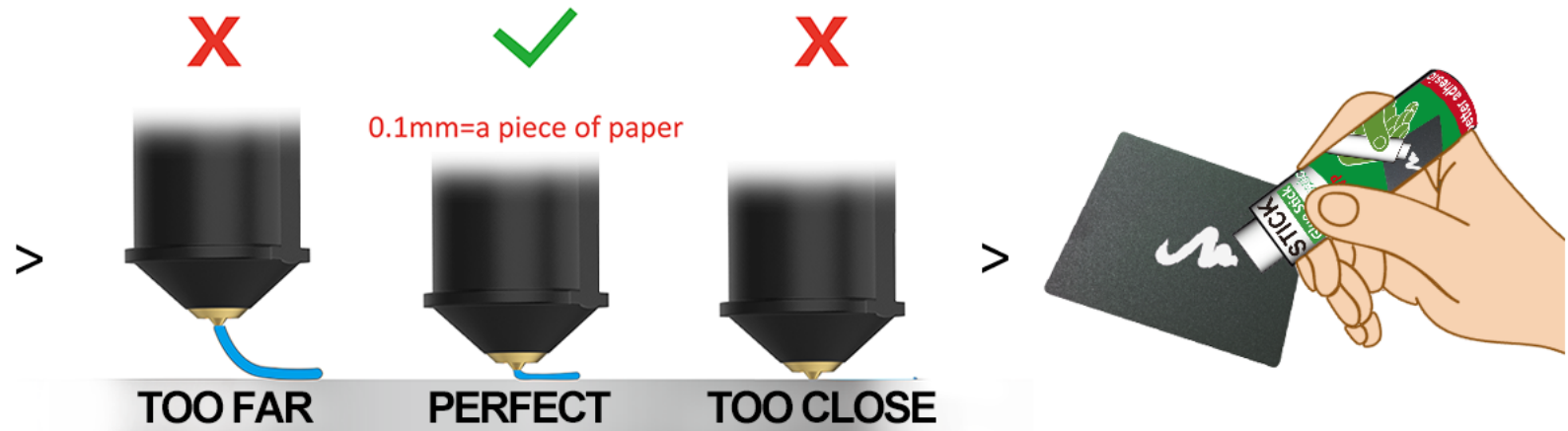
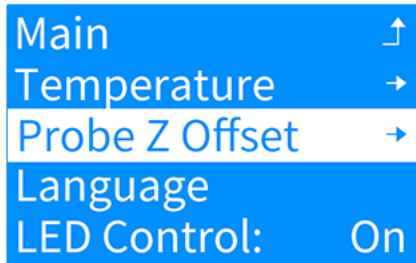

1. Use the Z-Offset function.

2. Adjust the nozzle-platform gap.

3. Apply glue to the platform.

④ What to Do If the Model or Raft Is Difficult to Remove?

After printing, if you find that the model is too small to handle, or the raft or brim is difficult to remove, this is a common situation.

The main cause is excessive adhesion between the first layer and the build platform or the model, or print temperature settings that are slightly too high.

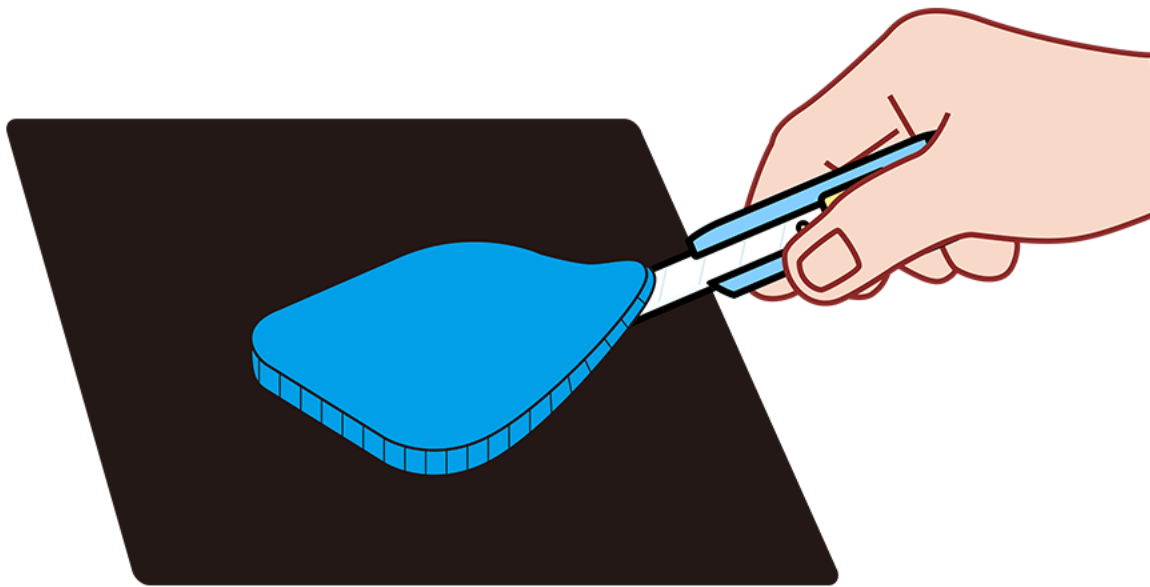

1. Let the platform cool down before removal
Wait until the build platform has completely cooled before attempting to remove the model.

2. Use tools to assist with removal
If removal is still difficult, use a plastic or metal scraper, craft knife, tweezers, or pointed scissors to gently lift the edge of the raft or brim, create a small gap, and then carefully peel it away.

Safety Reminder

When removing the model or using tools, handle with care. Avoid using excessive force or pointing sharp tools toward your body to prevent cuts or injury.